

JUDICIAL CENTER STORY

Struggling to meet the growing judicial needs of the people of Colorado and facing the urgent need to curb the climbing costs of maintaining its previous court building, the Colorado Judicial Department engaged the Urban Land Institute in 2005 to seek a solution. That solution is the Ralph L. Carr Colorado Judicial Center located at 14th and Broadway.

Designed to be an enduring building with a 100-year lifespan, the neoclassical Judicial Center anchors the south side of Civic Center Park. In addition to being a cornerstone of the Civic Center Park Master Plan, the stately location complements other dignified civic and cultural structures that occupy the park's perimeter, including the Colorado State Capitol, the Denver City and County Building, the Denver Art Museum, and the Denver Public Library Central Branch. The glass-domed atrium of the courthouse creates a stunning visual connection to the Colorado State Capitol, linking Colorado's Judicial, Executive, and Legislative Departments as co-equal branches of government.

Built to create a more efficient state judicial system, the Judicial Center consolidates seven judicial and legal agencies that leased office space in ten different Denver locations. A twelve-story office tower houses the judicial and legal agencies, while the courthouse is home to two courtrooms for the Court of Appeals, a courtroom for the Colorado Supreme Court, the Colorado Supreme Court Library, and an educational civics learning center.

The Judicial Center will also achieve energy efficiencies and is expected to achieve LEED Gold certification. Some of its sustainable features include highly efficient elevators and lighting, as well as drought-tolerant landscaping. In addition, 40% of the external building materials from the previous court building have been recycled into the Justice Center, and 78% of the construction waste has been diverted from landfills.

As an accessible, welcoming, and educational meeting place for the people of Colorado, the Ralph L. Carr Colorado Judicial Center preserves the state's heritage for future generations while serving as a symbol of the rule of law and a just society.

Cover photo: Jason A. Knowles © Fentress Architects

ABOUT RALPH L. CARR



Ralph Lawrence Carr served as the 29th Governor of Colorado from 1939 to 1943. Governor Carr was widely famed for opposing Japanese-American internment camps during World War II.

Carr was born in Rosita, Colorado, and grew up in Cripple Creek, Colorado, where he graduated from high school in 1905. He received his LLB from the University of Colorado.

BUILDING QUICK FACTS

Architect:	Fentress Architects
Contractor:	Mortenson Construction, Co.
Engineer:	Martin/Martin
MEP:	M-E Engineers
Developer:	Trammell Crow Company
Size:	700,000 SF Complex 440,128 SF Office Tower 197,000 SF Courts Facility 496 Parking Spaces
Project Start:	July 2009
Project Completion:	December 2012

Ralph L. Carr Colorado Judicial Center
2 East 14th Avenue
Denver, Colorado 80203
www.courts.state.co.us

Visitor Guide

RALPH L. CARR COLORADO JUDICIAL CENTER



**RALPH L. CARR COLORADO JUDICIAL CENTER
VISITOR MAP**

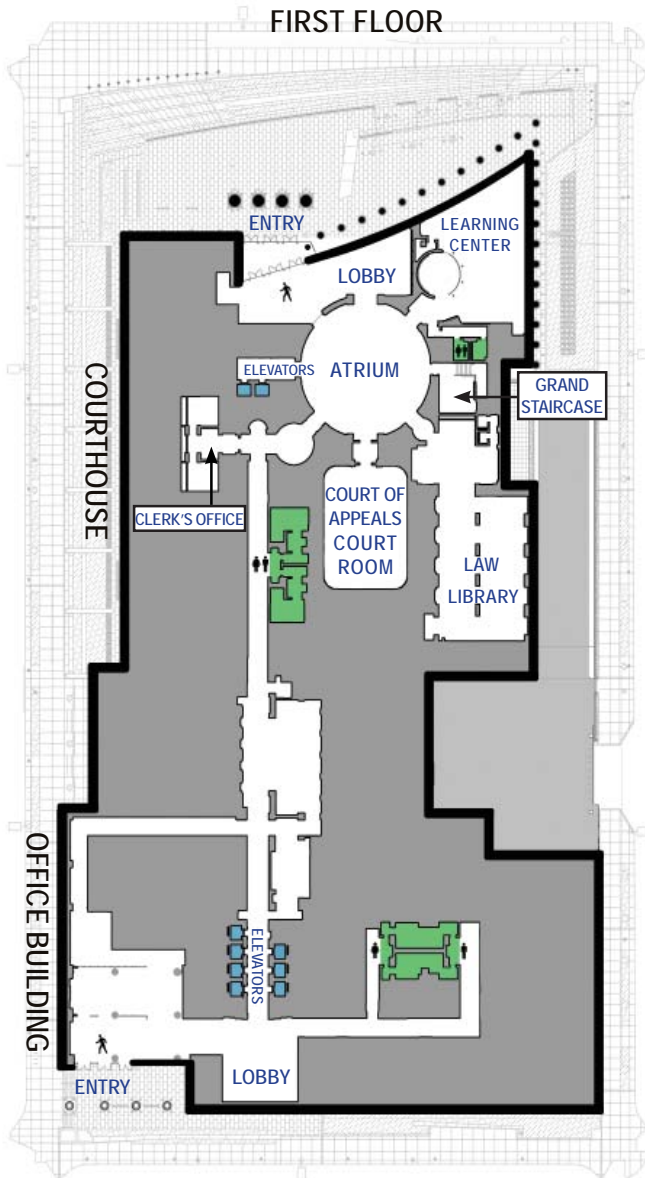

First Floor
Learning Center

An educational civics learning center open to the public to learn about the Colorado and federal court systems. It features interactive exhibits showcasing the role of the American justice system in the history of Colorado and of the United States.

COURTHOUSE THIRD FLOOR

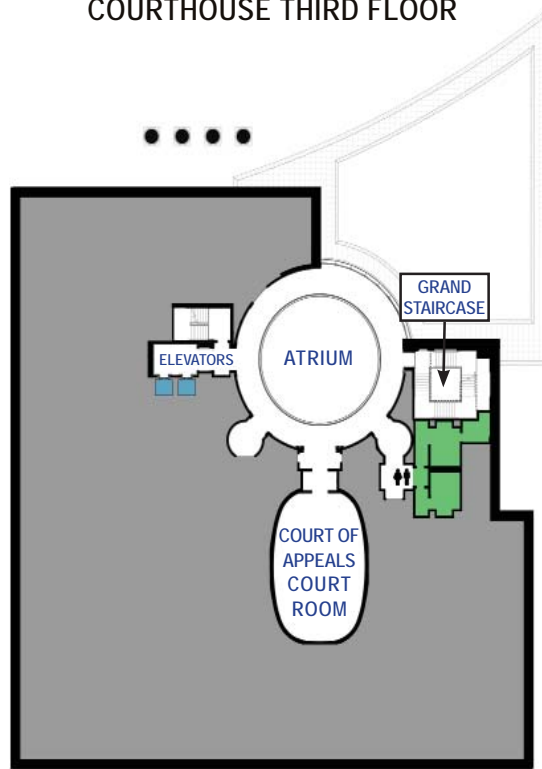

Supreme Court Law Library
Open to the public, the library is a resource to research legislative history, journals, secondary materials, practice treatises, and unpublished Court of Appeals opinions and other case law.

Court of Appeals Courtroom
One of two Court of Appeals courtrooms in the courthouse, this is the state's intermediate appellate court and takes most of its appeals from the state's trial courts.

Colorado Supreme Court and Court of Appeal's Clerk's Office
The Clerk of Court for the Colorado Supreme Court and the Colorado Court of Appeals accepts state appellate court case filings and maintains those appellate records that can be accessed by the public.

Second Floor
Private offices

COURTHOUSE FOURTH FLOOR

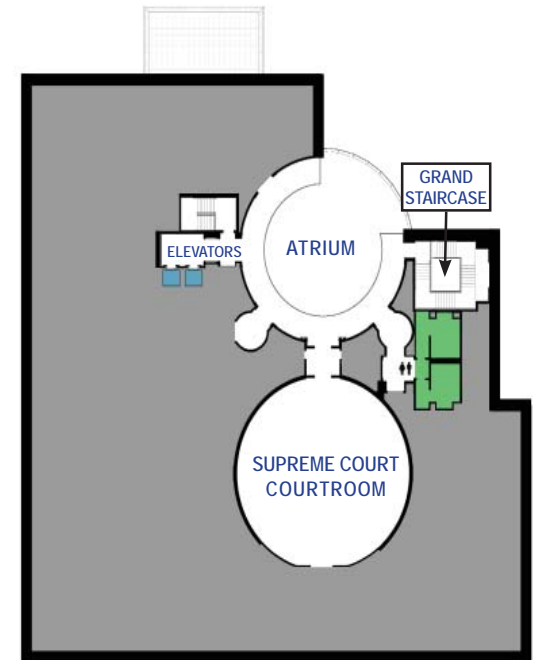

Third Floor
Court of Appeals Courtroom
One of two Court of Appeals courtrooms in the courthouse, this is the state's intermediate appellate court and takes most of its appeals from the state's trial courts.

Fourth Floor
Supreme Court Courtroom
The Colorado Supreme Court is the state's court of final appeal. The Supreme Court's decisions are binding on all other Colorado state courts. Requests to review decisions of the Colorado Court of Appeals are a majority of the Supreme Court's filings. The Supreme Court also has direct appellate jurisdiction over cases in which a statute has been held to be unconstitutional, cases involving decisions of the Public Utilities Commission, writs of habeas corpus, cases involving adjudication of water rights, summary proceedings initiated under Colorado's Election Code, and prosecutorial appeals concerning search and seizure questions in pending criminal proceedings.